

NSR TYPE A

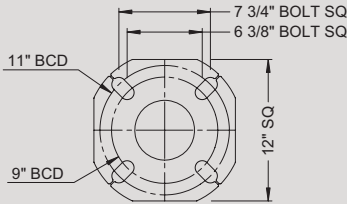

NSR TYPE B



**SPECIFICATIONS**

Product Number	Description	SQ. Pole (in)	Height (ft)	Anchor Bolt Diameter	Pole Type	Weight (lb)	Base Plate Type	Maximum EPA (sq.ft.)			
								80 mph	90 mph	100 mph	110 mph
101-70-NR410L-Fx	NSR 410 LD, Straight Round	4"	10'	3/4"	LD	67	A	18.0	14.0	11.0	9.0
101-70-NR412L-Fx	NSR 412 LD, Straight Round	4"	12'	3/4"	LD	77	A	15.0	11.5	9.0	7.0
101-70-NR416L-Fx	NSR 416 LD, Straight Round	4"	16'	3/4"	LD	98	A	10.0	7.5	5.5	4.5
101-70-NR418L-Fx	NSR 418 LD, Straight Round	4"	18'	3/4"	LD	109	A	8.5	6.0	4.5	3.5
101-70-NR420L-Fx	NSR 420 LD, Straight Round	4"	20'	3/4"	LD	119	A	7.0	5.0	3.5	2.5
101-70-NR420M-Fx	NSR 420 MD, Straight Round	4"	20'	3/4"	MD	168	A	11.5	8.5	6.5	5.0
101-70-NR424M-Fx	NSR 424 MD, Straight Round	4"	24'	3/4"	MD	199	A	8.0	5.5	4.0	2.8
101-70-NR512L-Fx	NSR 512 LD, Straight Round	5"	12'	1"	LD	110	B	24.0	18.5	15.0	12.5
101-70-NR516L-Fx	NSR 516 LD, Straight Round	5"	16'	1"	LD	137	B	17.0	13.0	10.5	8.5
101-70-NR516M-Fx	NSR 516 MD, Straight Round	5"	16'	1"	MD	187	B	26.0	20.0	16.0	13.5
101-70-NR520L-Fx	NSR 520 LD, Straight Round	5"	20'	1"	LD	163	B	12.0	8.5	7.0	5.5
101-70-NR520M-Fx	NSR 520 MD, Straight Round	5"	20'	1"	MD	226	B	19.0	14.5	11.5	9.5
101-70-NR520H-Fx	NSR 520 HD, Straight Round	5"	20'	1"	HD	286	B	25.5	19.5	15.5	13.0
101-70-NR524M-Fx	NSR 524 MD, Straight Round	5"	24'	1"	MD	264	B	14.0	10.0	8.0	6.5
101-70-NR524H-Fx	NSR 524 HD, Straight Round	5"	24'	1"	HD	337	B	19.5	14.5	11.5	9.5
101-70-NR530M-Fx	NSR 530 MD, Straight Round	5"	30'	1"	MD	322	B	8.5	5.5	4.0	3.0
101-70-NR530H-Fx	NSR 530 HD, Straight Round	5"	30'	1"	HD	413	B	12.5	9.0	7.0	5.5

Finishing Code: x=1 for Galvanized; x=3 for Powder Coated; x=5 for Galvanized & Powder Coated.

Pole Type: LD=Light Duty, MD=Medium Duty, HD=Heavy Duty.

Standard Tenon Size: 2 3/8" Outside Diameter x 5" Long.

Poles can be furnished with tenons with outside diameters of 2 7/8" or 3 1/2". Drilling pattern and top cap can also be provided.

Wind speeds (mph) in the table denote the maximum wind gust speed at the project site (i.e. gust factor included).

Maximum EPA rating includes fixture(s) and supporting arm(s) and is for standard pole installation on concrete bases/footings.

Pole designs based on AASHTO Standard Specifications for Structural Supports for Highway Signs, Luminaires, and Traffic Signals.

Contact Sales Team for custom sizes and/or custom applications.