

NSS TYPE A

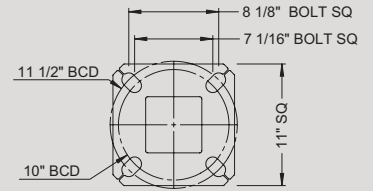

NSS TYPE B

SPECIFICATIONS

Product Number	Description	SQ. Pole (in)	Height (ft)	Anchor Bolt Diameter	Pole Type	Weight (lb)	Base Plate Type	Maximum EPA (sq.ft.)			
								80 mph	90 mph	100 mph	110 mph
101-70-NS410L-Fx	NSS 410 LD, Straight Square	4"	10'	3/4"	LD	80	A	32.0	26.0	21.0	17.0
101-70-NS412L-Fx	NSS 412 LD, Straight Square	4"	12'	3/4"	LD	93	A	27.0	21.5	17.0	14.0
101-70-NS416L-Fx	NSS 416 LD, Straight Square	4"	16'	3/4"	LD	118	A	20.0	15.5	12.0	9.5
101-70-NS418L-Fx	NSS 418 LD, Straight Square	4"	18'	3/4"	LD	131	A	16.5	13.0	10.0	7.5
101-70-NS420L-Fx	NSS 420 LD, Straight Square	4"	20'	3/4"	LD	144	A	14.0	10.5	8.0	6.0
101-70-NS420M-Fx	NSS 420 MD, Straight Square	4"	20'	3/4"	MD	205	A	22.0	17.0	13.0	10.5
101-70-NS424L-Fx	NSS 424 LD, Straight Square	4"	24'	3/4"	LD	170	A	10.0	7.0	5.0	3.5
101-70-NS424M-Fx	NSS 424 MD, Straight Square	4"	24'	3/4"	MD	242	A	16.5	12.0	9.0	7.0
101-70-NS430M-Fx	NSS 430 MD, Straight Square	4"	30'	3/4"	MD	299	A	10.0	7.0	4.5	3.0
101-70-NS520L-Fx	NSS 520 LD, Straight Square	5"	20'	1"	LD	186	B	21.0	16.0	12.5	9.5
101-70-NS520M-Fx	NSS 520 MD, Straight Square	5"	20'	1"	MD	265	B	36.0	28.0	22.0	17.5
101-70-NS520H-Fx	NSS 520 HD, Straight Square	5"	20'	1"	HD	336	B	49.0	38.0	30.0	24.0
101-70-NS524L-Fx	NSS 524 LD, Straight Square	5"	24'	1"	LD	218	B	15.5	11.5	8.5	6.0
101-70-NS524M-Fx	NSS 524 MD, Straight Square	5"	24'	1"	MD	313	B	27.5	21.0	16.0	12.5
101-70-NS524H-Fx	NSS 524 HD, Straight Square	5"	24'	1"	HD	399	B	37.0	29.0	22.5	18.0
101-70-NS530L-Fx	NSS 530 LD, Straight Square	5"	30'	1"	LD	266	B	9.5	6.0	3.5	2.0
101-70-NS530M-Fx	NSS 530 MD, Straight Square	5"	30'	1"	MD	385	B	18.5	13.5	9.5	7.0
101-70-NS530H-Fx	NSS 530 HD, Straight Square	5"	30'	1"	HD	492	B	26.0	19.0	14.5	11.0

Finishing Code: x=1 for Galvanized; x=3 for Powder Coated; x=5 for Galvanized & Powder Coated.

Pole Type: LD=Light Duty, MD=Medium Duty, HD=Heavy Duty.

Standard Tenon Size: 2 3/8" Outside Diameter x 5" Long.

Poles can be furnished with tenons with outside diameters of 2 7/8" or 3 1/2". Drilling pattern and top cap can also be provided.

Wind speeds (mph) in the table denote the maximum wind gust speed at the project site (i.e. gust factor included).

Maximum EPA rating includes fixture(s) and supporting arm(s) and is for standard pole installation on concrete bases/footings.

Pole designs based on AASHTO Standard Specifications for Structural Supports for Highway Signs, Luminaires, and Traffic Signals.

Contact Sales Team for custom sizes and/or custom applications.